

First Term Evaluation 2017-18

Mathematics

Standard : 5

Time : 2 hrs

Instructions

1. 15 minutes are allotted as cool of time. Read and comprehend the questions.
2. Seven activities are given. Answer any **five**.

Activity 1

Write 246539 on the number chain given below.

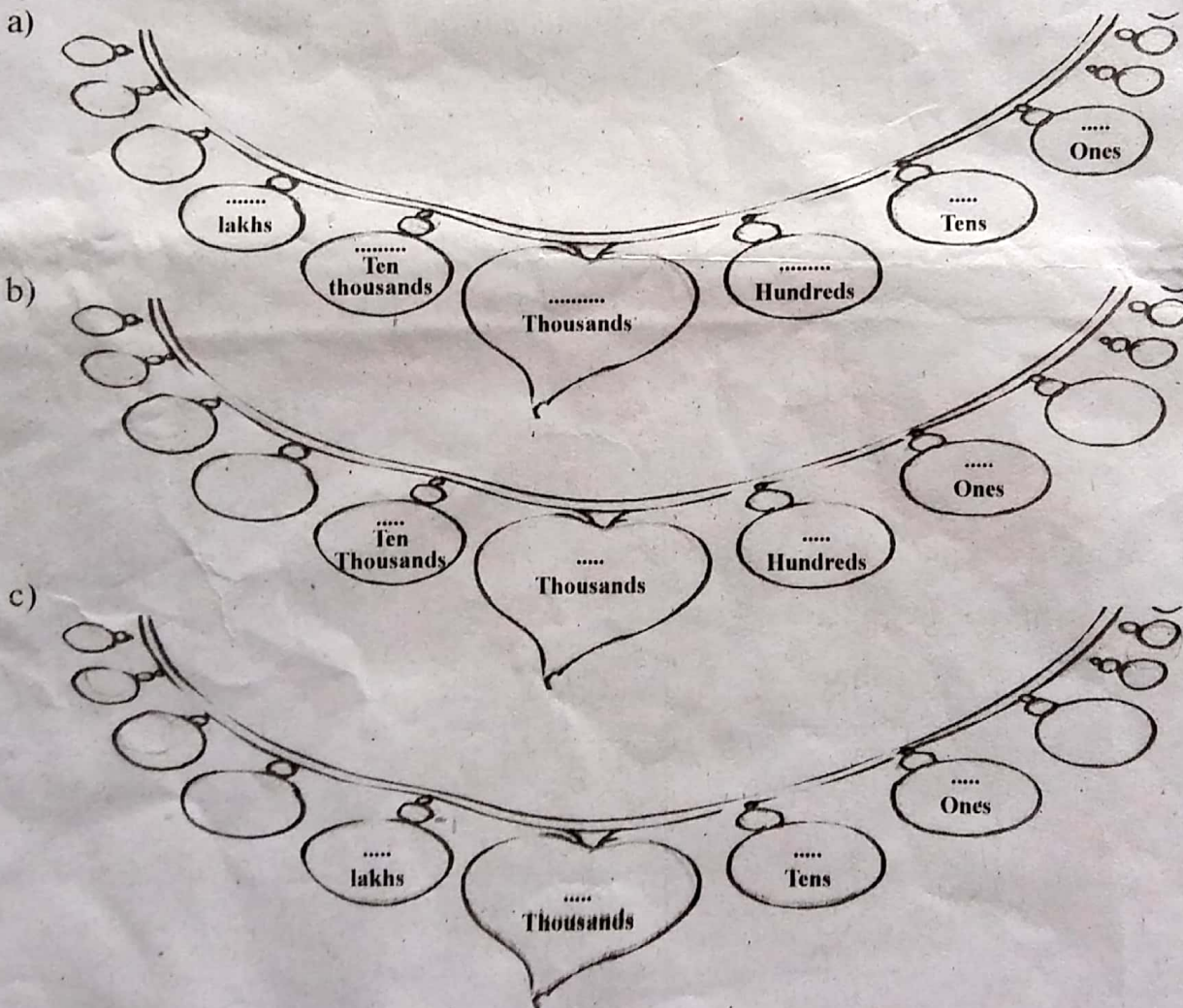

Activity 2

In connection with Green Kerala Mission the saplings distributed in the schools in 5 districts are given below.

District	No. of saplings
Thrissur	214930
Kozhikkode	263789
Palakkad	214312
Idukki	164315
Alappuzha	175367

- Which district distributed the largest number of saplings?
- Arrange the districts according to the number of saplings distributed? (From largest to the smallest)
- Find the total number of saplings distributed for Thrissur and Palakkad?
- Find the number of saplings distributed more in Kozhikkode than Idukki?

Activity 3

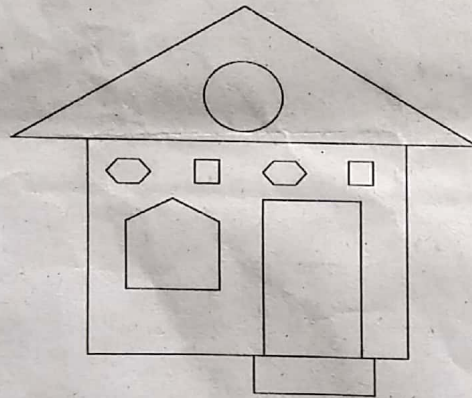

- Write the name of the shapes used to draw this house?
- Write the peculiarities of each shape?

Shape	Peculiarities
.....
.....
.....
.....
.....
Hexagon	6 sides

Activity 4

Five groups in a school collected books for the class library. The following table shows the number of books collected.

Group	Number of books	Total number of books collected
1	8 bundles with 10 books each
2	10 bundles with 15 books each
3	4 bundles with 20 books each
4	5 bundles with 25 books each

- Write the number of books collected by each groups in the table?
- Find the total number of books collected by all groups?
- The books are equally divided among 5 classes. Find the number of books that each class received?

Activity 5

- Find the total number of squares in this picture?
- Draw the figure. The sides of the square are 3 cm each. Use only scale and set square.

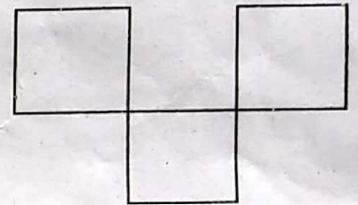

Activity 6

Complete the boxes given below.

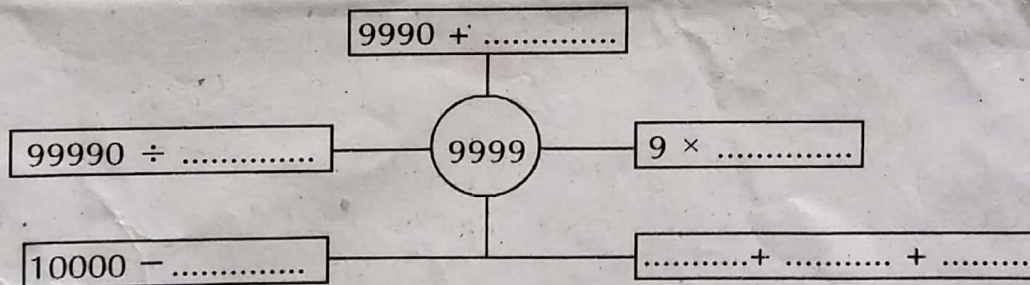

Activity 7

District Panchayat decided to allot Rs.9500/- for high schools and Rs.7500/- for Primary Schools to start Bio diversity park. If there are 85 High Schools and 275 Primary Schools in the district.

- What is the amount allotted to High Schools ?
- What is the amount allotted to Primary Schools ?
- Find the total allotment for both Primary and High Schools ?